



■ **Features**

- Used in DC-Link circuits, can replace electrolytic capacitor
- PP film design, good temperature characteristics
- Stable capacity
- Low ESR, high ripple current handing capabilities
- Low Ls
- Long life
- Self-healing property
- Aluminum case , filled with fire-retardant resin

■ **Applications**

- Used in Inverters of wind power and solar power
- Transportation: HEV or EV
- Welders, Elevators, Motor Driver systems

■ **特点**

- 直流滤波用，可替代电解电容器
- 采用聚丙烯薄膜，温度特性好
- 容值稳定，变化率小
- 等效串联电阻小，能承受较大的纹波电流
- 自感小
- 寿命长
- 有自愈性
- 铝壳，阻燃树脂灌封

■ **应用场合**

- 风能发电，太阳能发电
- 交通工具，如：电动车和混合动力车
- 焊接设备，电梯，电机驱动

■ **外型图 Dimensions**

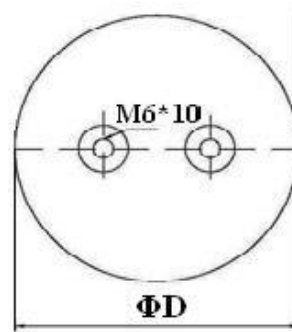
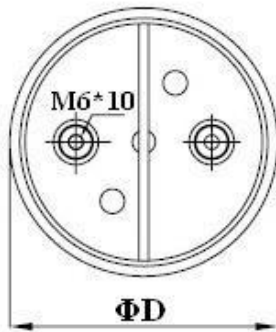
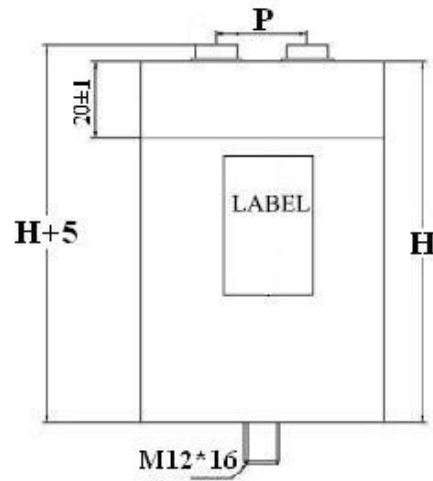
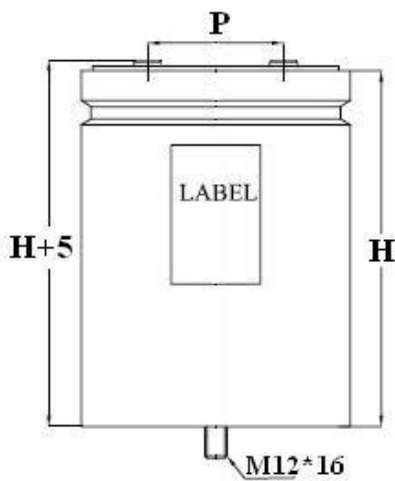

mm

ΦD	85	116
P(±0.5)	32	50
H(±1)	95~230	

mm

ΦD	76	86
P(±0.5)	32	32
H(±1)	95~225	



■ 标识 Marking

 ——— 1
 CBB131 ——— 2
 420 μ F \pm 10% ——— 3
 $U_R=1100V_{DC}$ ——— 4
 $U_{TC}=3000V$ 50/60Hz ——— 5
 -55~+85 $^{\circ}C$ IEC61071 ——— 6
 Discharge before handling ——— 7
 C20F01 ——— 8

NO	项 目 Item
1	商 标 Brand
2	产品系列 Products series
3	容量和偏差 Capacitance and Tolerance
4	额定电压 Rated voltage
5	端子与铝壳电压 UTC Voltage Between Terminals and Case
6	温度范围 Temperature Range 引用标准 Reference Standard
7	安全警示 Safety warning
8	年度标记 Year code

■ 性能特性 Specifications

项目 Item	特性 Characteristics
引用标准 Reference Standard	GB/T 17702 (IEC 61071)
气候类别 Climatic Category	55/85/56
工作温度范围 Operating Temperature Range	-55~+85 $^{\circ}C$ [$\Theta_{max}(hotspot) \leq 85^{\circ}C$]
存储温度范围 Storage Temperature Range	-55~+85 $^{\circ}C$
额定电压 U_R Rated Voltage	600~1500 V_{DC}
电容量范围 Capacitance Range	100 ~ 2000 μ F
电容量偏差 Capacitance Tolerance	$\pm 5\%$ (J), $\pm 10\%$ (K)
端子与端子电压 U_{TT} Voltage Between Terminals	$1.5 \times U_{RDC}$, 10S
端子与铝壳电压 U_{TC} Voltage Between Terminals and Case	$2 \times U_i + 1000$ or 3000 V_{AC} 取大者, 10 s(20 $^{\circ}C$, 50 Hz)
介质损耗角正切 Dielectric Dissipation Factor	$\leq 2 \times 10^{-4}$
绝缘电阻 Insulation Resistance	$\geq 5000 M\Omega \cdot \mu F$ (20 $^{\circ}C$, 100 V_{DC} , 1min)
过电压 Over Voltage	1.1 U_R (30 % of on-load-duration)
	1.15 U_R (30 min/day)
	1.2 U_R (5 min/day)
	1.3 U_R (1 min/day)
	1.5 U_R (30 ms every time, 100 ms/day)
最大电极扭矩 Max Torque of terminals	M6: 5 Nm M8: 6 Nm M10: 8 Nm
最大安装扭矩 Max Torque of installation	12 Nm



预期寿命 t_{LD} Life Expectancy	100000 hours ($U_R, \Theta_{hotspot}=70\text{ }^{\circ}\text{C}$)
失效率 Failure Rate	50 Fit

■ 规格标准 **Standard Ratings**

U_R (V)	C_R (μF)	P/N	I_{max}^* (A)	$R_{th}[K.W]$]	\hat{I} (A)	R_S ($m\Omega$)	L_S (nH)	D (mm)	H (mm)
800	350	FCC2KDL357*H12003*	60	4.7	3500	2.4	≤ 60	76	120
	400	FCC2KDL407*H13603*	56	4.6	3600	2.8	≤ 60	76	136
	480	FCC2KDL487**12003*	61	4.7	3840	2.3	≤ 60	85/86	120
	550	FCC2KDL557**13603*	58	4.6	3850	2.6	≤ 60	85/86	136
	970	FCC2KDL977*P12005*	69	5.0	5820	1.7	≤ 60	116	120
	1000	FCC2KDL108**22505*	79	4.0	6000	1.6	≤ 80	85/86	225
	1100	FCC2KDL118*P13205*	67	4.9	6600	1.8	≤ 60	116	136
900	1900	FCC2KDL198*P23005*	100	2.7	11400	1.4	≤ 80	116	230
	350	FCCR2DL357*H12003*	54	4.7	3500	2.9	≤ 60	76	120
	400	FCCR2DL407*H13603*	51	4.6	3600	3.3	≤ 60	76	136
	480	FCCR2DL487**12003*	55	4.7	3840	2.8	≤ 60	85/86	120
	550	FCCR2DL557**13603*	53	4.6	3850	3.1	≤ 60	85/86	136
	970	FCCR2DL977*P12005*	60	5.0	5820	2.2	≤ 60	116	120
	1000	FCCR2DL108**22505*	69	4.0	6000	2.1	≤ 80	85/86	225
1100	1100	FCCR2DL118*P13205*	60	4.9	6600	2.3	≤ 60	116	136
	1900	FCCR2DL198*P23005*	88	2.7	11400	1.9	≤ 80	116	230
	170	FCCA3DL177*H09503*	50	5.6	1700	3.0	≤ 60	76	95
	230	FCCA3DL237*H12003*	50	4.7	1840	3.4	≤ 60	76	120
	240	FCCA3DL247**09503*	56	5.1	1920	2.5	≤ 60	85/86	95
	260	FCCA3DL267*H13603*	50	4.6	2080	3.6	≤ 60	76	136
	310	FCCA3DL317**12003*	57	4.7	2480	2.6	≤ 60	85/86	120
	350	FCCA3DL357*H17503*	68	4.3	2800	2.0	≤ 80	76	175
	420	FCCA3DL427**13603*	56	4.6	3360	2.8	≤ 60	85/86	136
	420	FCCA3DL427**15503*	75	4.5	4200	1.6	≤ 60	85/86	155
	450	FCCA3DL457*P09505*	61	5.4	4500	2.0	≤ 60	116	95
	480	FCCA3DL487**17303*	72	4.3	4800	1.8	≤ 80	85/86	175
	600	FCCA3DL607**22503*	71	4.0	6000	2.0	≤ 80	85/86	225
	610	FCCA3DL617*P12005*	60	5.0	4880	2.2	≤ 60	116	120
680	FCCA3DL687*P13605*	58	4.9	5440	2.4	≤ 60	116	136	
940	FCCA3DL947*P17505*	99	3.4	8460	1.2	≤ 80	116	175	
1100	FCCA3DL118*P23005*	100	2.7	9900	1.3	≤ 80	116	230	
1200	FCCA3DL128*P23005*	100	2.7	10800	1.3	≤ 80	116	230	
1200	220	FCC3BDL227*H13603*	46	4.6	2200	4.2	≤ 60	76	136
	300	FCC3BDL307**13603*	50	4.6	3000	3.5	≤ 60	85/86	136
	450	FCC3BDL457*P13605*	54	4.9	4050	2.8	≤ 60	116	136
	470	FCC3BDL477*L22503*	67	4.0	4230	2.2	≤ 80	86	225
1300	100	FCCO3DL107*H09503*	46	5.6	1400	3.4	≤ 60	76	95
	160	FCCO3DL107*H09503*	50	4.7	1920	3.6	≤ 60	76	120
	160	FCCO3DL107*H09503*	53	5.1	2240	2.8	≤ 60	85/86	95
	220	FCCO3DL107*H09503*	53	4.7	2640	3.0	≤ 60	85/86	120
	310	FCCO3DL107*H09503*	58	5.4	3720	2.2	≤ 60	116	95
	310	FCCO3DL107*H09503*	45	4.3	3720	4.9	≤ 60	85/86	175



CBB131 DL SERIES

	420	FCCO3DL107*H09503*	57	5.0	4200	2.5	≤60	116	120
	470	FCCO3DL107*H09503*	65	4.0	4700	2.4	≤80	85/86	225
	620	FCCO3DL107*H09503*	92	3.4	5580	1.4	≤80	116	175
	800	FCCO3DL107*H09503*	95	2.7	6400	1.5	≤80	116	230
1500	400	FCCC3DL407*P15505*	85	4.3	4000	1.3	≤60	116	155

Customer products are available on request.

* I_{max} 为环境温度在 40℃时允许的最大纹波电流

Maximum permissible Ripple current at the ambient temperature of 40℃

* R_{th} 为产品热点到环境的热阻（自然冷却）

The thermal Resistance from hotspot to ambient environment.(Natural cooling)

■ 预期寿命曲线 Expected lifetime curve

